

# ALTERNATOR WIRING GUIDE

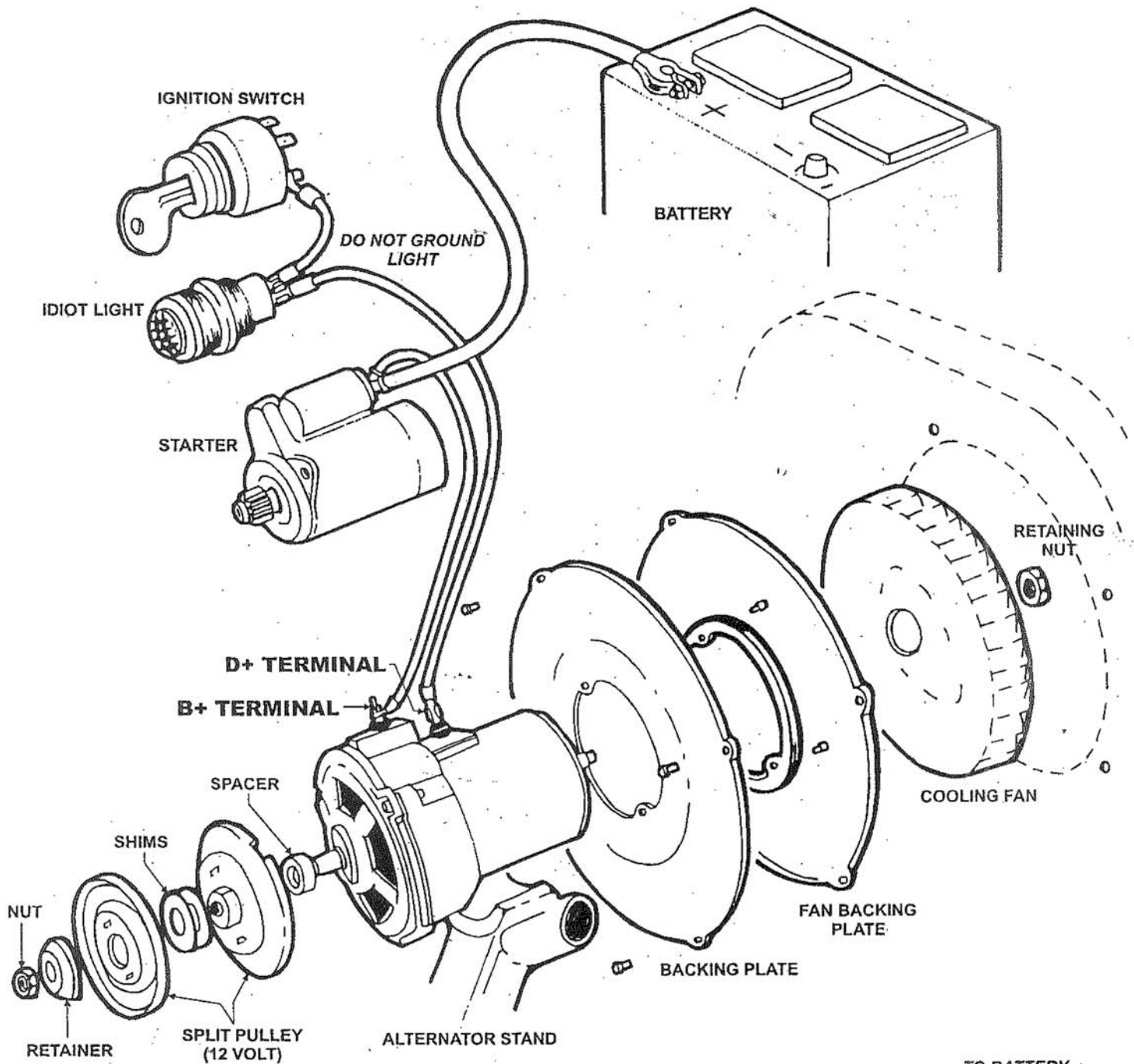

BEFORE STARTING REMOVAL & INSTALLATION  
**DISCONNECT BATTERY**

Remove Generator and Regulator from vehicle. Discard DF & D+ wires. Secure Idiot Light Wire (61) to the D+ terminal on the Alternator, in most all cases the wire will have to be made longer in order to secure it to the Alternator. In cases where the Regulator is mounted under the back seat, secure both B+ wires removed from the regulator together and insulate connection. Now secure a wire to the Battery terminal on the starter solenoid and connect the other end to the B+ terminal on the Alternator.

