



2" Tow Bars

VW Sedan Tow Bar (2")

Designed for Standard VW Sedans and Hooks to the Front Axle Beam. No Tools are required for installation. For use with 2" Balls Only.

NOTE: Does not fit Super Beetle

Universal Tow Bar (2")

A tow bar for a multitude of uses! It's basic design allows adaptation to many vehicles. For towing Superbugs there is separate mount plate (#6510), which after installed, remains part of the car for easy clip on installation of the Universal Tow Bar. Tow bars are made of strong 120 wall tubing.

Universal Mounting Plate for Universal Tow Bar

The Universal Mounting Plate is designed to fit almost any car, very popular with the fiberglass buggy crowd. You can leave it installed for a quick and easy hook-up to the CB #6507 Universal Tow Bar.



6505	VW Sedan Tow Bar (2")
6507	Universal Tow Bar (2")
6510	Universal Mounting Plate for Universal Tow Bar

OVERSIZE ITEM - CAN BE SHIPPED UPS.

(Call for Shipping Quote before ordering oversized item.)

Collapsible Lug Wrench

It folds to a small 14 1/2" by 3" for convenient storage in your tool box, trunk, or under the seat.

Includes these popular sizes: 17mm, 3/4"-19mm, 7/8" and 13/16" Lug Nuts).



4234	Collapsible Lug Wrench
------	------------------------

LAT High Performance Assembly Lube

Provides extreme protection on all moving components including cams lobes, lifters, push-rods, valve train, rod and main bearings before lubrication can be supplied by the oil pump.

It offers high-adhesion characteristics, providing an excellent barrier against rust and corrosion. Sold in a 8 oz bottle.



7092	LAT High Performance Assembly Lube (8 fl oz) NEW!
------	--

Carburetor Flow Meters

Allows you to quickly dial in multiple carbs or throttle bodies.



- 6537 STE Carburetor Flow Meter (SK) 40 to 55mm Intake Dia.
- 6534 STE Carburetor Flow Meter (BK) 48 to 53mm Intake Dia.
- 6538 Adapter to fit BK - fits boresizes 1 5/8 - 2"

Crankshaft Gear Puller

Solves the problem of removing the crankshaft timing gear. For use on all Type I, II, III & IV engines 40 hp and later.

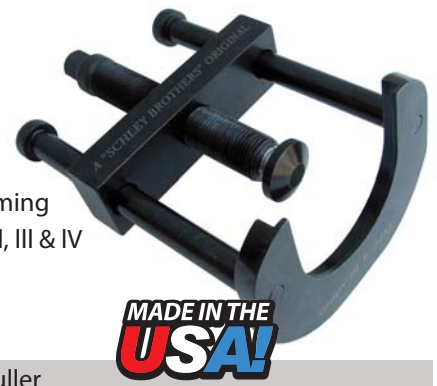

- 6535 Crankshaft Gear Puller

MADE IN THE USA!

Valve Spring Removal Tool

Allows removal and installation of valve springs while the engine is both fully assembled and still in the car. The use of a ratchet as a lever handle allows it to be rotated at any angle for maximum clearance.



- 6504 Valve Spring Removal Tool

Bench Top Engine Stand

Don't be fooled by cheap imitations! Constructed from heavy gauge steel for improved strength and rigidity to outlast any other style of bench top engine stand.



- 6554 Bench Top Engine Stand

Distributor Drive Gear Puller

Use this tool to remove your Distributor Drive Pinion.



- 6501 Distributor Drive Gear Puller

Crankshaft Oil Seal Tool

Used to properly install the Rear Main Seal on your Engine Case.



- 6529 Crankshaft Oil Seal Tool

Deck Height Measuring Tool

This Deck Height Measuring Tool allows you to accurately determine top dead center when assembling an aircooled longblock.



- 6546 Deck Height Measuring Tool

Universal Flywheel Lock

Use this Universal Flywheel Lock when installing a Gland Nut on the Flywheel.



- 1310 Universal Flywheel Lock

VW Valve Adjusting Tool

Quickly and easily adjust your valves with one tool. Can be used on all VW rocker arms using 13mm Jam Nuts for increased accuracy and the convenience of using one tool.



6572 VW Valve Adjusting Tool

Case Savers

Used to drill and tap your engine case in order to insert case savers.

14mm width and 2.0 Thread Pitch.



6519 Case Saver, 14mm O.D. x 10mm I.D. (2.0mm TP)

6536 Case Saver, 12mm O.D. x 8mm I.D. (1.5mm TP)

6518 Case Saver Tap, M14 x 2.0

Adjustable Push Rod Tool

Used for setting up Push Rod length. Ends guess work and wasted Push Rods cut the wrong length.



Effective measuring range is 10.500" to 11.500".

1664 Adjustable Push Rod Tool

Crankshaft Pulley Pulling Aid

The perfect tool to help you remove a crankshaft pulley.



6561 Crankshaft Pulley Pulling Aid

Flywheel & Crankshaft Drill Jig

Gives you the correct positions when drilling for 8 dowel pins.



6548 Flywheel & Crankshaft Drill Jig

Cylinder Head CC Measuring Kit

Includes 60 mL Syringe and 3 discs (85.5, 90.5/92 & 94mm bore)

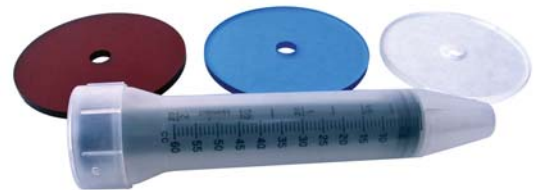

6525 Cylinder Head CC Measuring Kit

End Play Measuring Tool

NEEDS DESCRIPTION.



6547 End Play Measuring Tool

Oil Filler & Breather Nut Tool

Use this tool to easily remove the Gland Nut in the Oil Filler. Attaches to a 1/2" ratchet.



6509 Oil Filler & Breather Nut Tool

Oil Piston Puller

NEEDS DESCRIPTION.t



6549 Oil Piston Puller

Transmission Drain/Fill Plug Tool

17mm Transmission Drain/Fill Plug Tool.



6517 Transmission Drain/Fill Plug Tool

Lifter Retainer Springs

Holds four lifters in case bore during engine assembly.

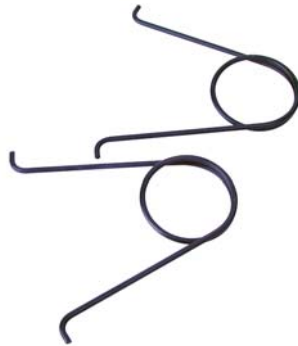

6506 Lifter Retaining Springs (pair)

Wrist Pin Tool

Also known as a Piston Pin Tool.



6551 Wrist Pin Tool

Oil Pump Puller

The Oil Pump Puller is used to remove Oil Pumps from your engine case.

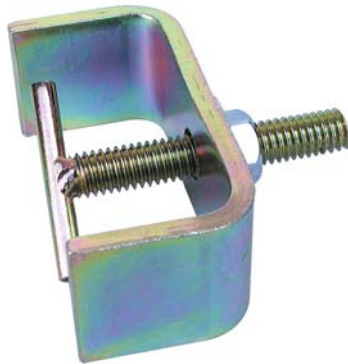

6528 Oil Pump Puller

Clutch Pilot Tool

This Clutch Pilot / Alignment Tool is used to align the Pressure Plate and Clutch during installation.



6516 Clutch Pilot Tool

Clutch Cable Wing Nut Adjustment Tool

Makes adjusting Clutch Cables 100% Easier!
The larger OD of the tool gives increased torque and a much better grip.



6569 Clutch Cable Wing Nut Adjustment Tool

Hub Cap Removal Tool

Use this handy tool to easily remove your VW hubcaps, and also to plug the unsightly jacking point holes on your vehicle.

Sold in Pairs.



4429 Hub Cap Removal Tool (set of 2)

12 Point Velocity Joint Tool

You'll need this tool to remove and install VW and Porsche Rear Velocity Joints. Shipped with a adapter to snap right on to your 18" drive ratchet.



6511 12 Point Velocity Joint Tool

Valve Guide Tool

This Valve Guide Tool makes installation a snap!

Designed for installing 8mm valve guides.



6513 Valve Guide Tool

Solder-Less Terminal Kit

175 pieces of selected top quality wire terminals. The kit includes Butt Connectors, Lug Ring Connectors, Insulated Lugs, Rings, Spades, Flanged Spades, Quick Connectors, and much, much more. All you need is wire and a crimping tool - this kit has the rest.



2410 Solder-Less Terminal Kit

Econo Crankshaft Oil Seal Kit

Install your flywheel seal with ease and precision. Eliminates hammering, guess work, and damaged seals. Uses your gland nut to press in the new seal.



6589 Econo Crankshaft Oil Seal Tool

Weather Pak

Wraps and crimps the connector around the wire. This is a 100% essential tool if you plan on modifying your present harness, or designing your own fuel injection system.



7153 Weather Pak Crimping Tool

7155 Weather Pak Extraction Tool Kit (3 piece)

Super Duty Sockets

Extra Large Diameter Super Duty Sockets make removing or tightening those large Nuts a breeze! Used to remove or tighten Gland Nuts, Sedan Axle Nuts or Bus Axle Nuts.



6584 SD 36mm Socket - fits stock gland nut & Sedan axle nut

6585 SD 40mm Socket - fits SCAT Racing Gland Nut

6586 SD 41mm Socket

6587 SD 46mm Socket - fits Bus axle nut

Rear Axle Nut Tool

The 36mm is for use on Bugs, and the 46mm is for use on Busses.



6502 Rear Axle Nut Tool - 36mm

6503 Rear Axle Nut Tool - 46mm

Tapered Ring Compressors

Hard-Anodized and Teflon-coated for low friction and prolonged wear resistance.

Manufactured by Wiseco.



Size	85.5mm	87mm	88mm	90.5mm	92mm	94mm
Part#	6573	6574	6575	6576	6577	6578

Brad Penn Racing Oil

The term "100% Pure Pennsylvania Grade Crude Oil" has long carried with it an industry connotation for being one of the best sources of high quality lubricant base stocks in the world. The BRAD PENN® refinery still refines 100% Pennsylvania grade crude oil. PA grade crude oil is a very thermally stable paraffinic crude oil which contains no asphaltic constituents. This makes it an ideal choice from which to refine premium quality base oils. Because they use only one crude stock, their refined products are of consistently high quality and performance.

Formulated using a unique base oil cut from our tower, which gives our Penn Grade 1® High Performance Oils exceptional film strength. This unique base oil causes our Penn Grade 1® High Performance Oil to cling tenaciously to engine parts to minimize wear during high engine torque loading and/or periods of heavily stressed operation such as those experienced during competition. This same oil "cling" helps prevent "dry-start" conditions to minimize wear even after the engine has been sitting idle for extended periods.



FEATURES:

- 1500 PPM ZDDP
- 1340 PPM Phosphorous
- Contains high levels of detergent / dispersants
- Helps to protect critical parts from deposits in highly stressed engines
- Utilizes unique base oil cut that clings to engine parts and minimizes dry start wear
- Reduces internal friction
- Increases Horsepower
- Excellent wear protection



Oil Weight	One Quart	Case of 12
30wt Brad Penn Racing Oil	3017	3039
40wt Brad Penn Racing Oil	3021	3029
50wt Brad Penn Racing Oil	3022	3030
70wt Brad Penn Racing Oil	3023	3031
30wt Brad Penn Break-In Oil	3020	3028

Oil Weight	One Quart	Case of 12
10w40 Brad Penn Racing Oil	3018	3040
15w40 Brad Penn Racing Oil	3019	3041
10w30 Brad Penn Racing Oil	3025	3033
20w50 Brad Penn Racing Oil	3026	3034
75w90 Syn Bio Brad Penn Racing Oil	3027	3035

LAT High Performance Synthetic Racing Oil

*The Next Generation
in Performance
Lubricants!*

Blended from the highest quality Group IV and Group V synthetic base oils. LAT's exclusive new LFR additive provides high RPM protection by reducing friction, scuffing, and galling while creating lower engine temperatures. Offering excellent wear protection under extreme conditions with a high flash point and resistance to thermal breakdown. Engines with tight tolerances will benefit from our oil with less oil drag and improved horsepower and torque.

Oil Weight	One Quart	Case of 12
0w20 LAT Synthetic Racing Oil	3053	3054
20w50 LAT Synthetic Racing Oil	3057	3058

Features:

- High RPM protection
- Extreme wear protection
- Reduces internal friction
- Maximizes horsepower & torque by as much as 6%



Gasgacinch

The professional engine sealer with multiple uses, like sealing a case half together. It's great because Gasgacinch stays flexible, and never becomes brittle. It grows with the engine case as it heats up. Use it to revive old gaskets, or hold gaskets in place during assembly. It withstands shock pressure, heat and hot oils.



3901 Gasgacinch

3M Adhesive

Thousands of uses! Carpets and door seals can be quickly installed when using 3M Adhesive.

It resists oil, solvents, and grease so you can even use it on engines!



3902 3M Weatherstrip Adhesive (Black)

3903 3M Super Weatherstrip and Gasket Adhesive (Yellow)

LOCTITE Thread-Locker

Available for many purposes.



7081 LOCTITE 640 - Sleeve Retainer (High Strength)

7082 LOCTITE 242 - Threadlocker Blue (Medium Strength)

7083 LOCTITE 271 - Threadlocker Red (High Strength)

RTV Silicone

RTV Silicone is available for many purposes.



7080 RTV Silicone - Black (for indoor or outdoor door seals)

7084 Ultra Grey Gasket Maker (makes any size or shape gasket)

7087 RTV Silicone - Orange (high temperature sealing)

J-B Weld

The world's best cold weld compound.

Drill it, machine it and even turn it on a lathe.

*Don't scrap it,
J-B Weld it!*



7086 J-B Weld

Aluminum RTV Silicone

The perfect choice for sealing up your cylinders to your engine case. The pressurized can makes this silicone come out just like cheese whiz for clean, accurate, and quick application.



7088 RTV Silicone - Aluminum (8 oz)

Anti-Seize Lubricant

Great to use on spark plugs, lug nuts, and most of the hardware that holds your VW together.



7089 Anti-Seize Lubricant (8.5 oz)

LAT Threadlocker

Superior to traditional lock and bevel washers. Provides security against thread "back off" due to shock and vibration. Prevents seepage and "rust lock".



7090 LAT Threadlocker - Oil Tolerant Removable (50 mL)

7091 LAT Threadlocker - High Strength (50 mL)